

# 0.01 Mircon water purification

## 0.01微米精密过滤

### 0.01 micron filter

Without any chemical substances, relying on the ultrafiltration membrane surface of the microporous mesh for screening, to intercept harmful substances, to achieve purification effect.

### 0.01微米净水孔

不添加任何化学物质，依靠超滤膜表面密布的微孔进行筛分，从而截留有害物质，达成净化效果。



What is the concept of 0.01 microns

0.01微米是什么概念

$0.01 \times 1000 = 1 \text{ hair}/1 \text{ 根头发}$

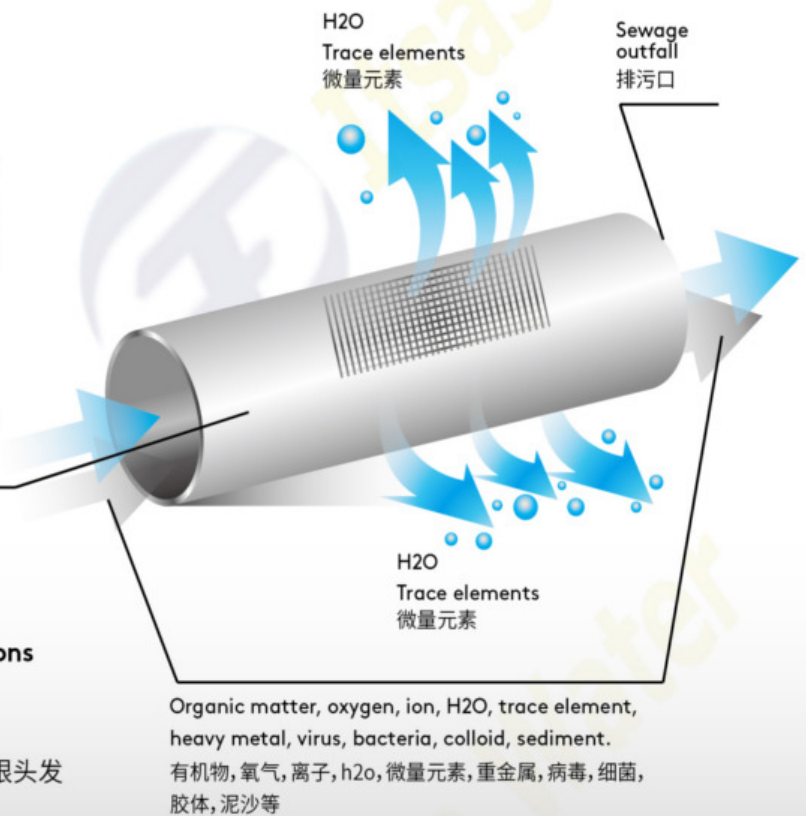

## Precision 0.01 micron filter principle

### 精密0.01微米过滤原理

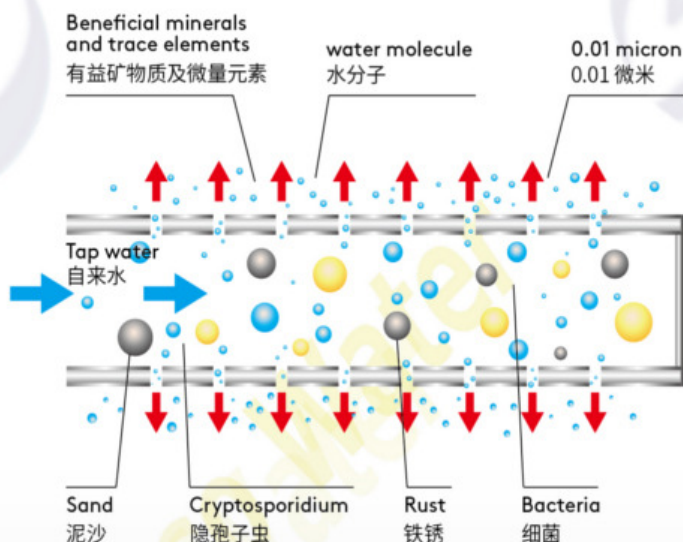

The use of PAN alloy ultrafiltration membrane wire, per meter long ultrafiltration membrane wall has 8 billion 0.01 micron micropores whose pore diameter is only water molecules, the beneficial minerals and trace elements in the water can pass, and the smallest bacterial volume More than 0.02 microns, because the bacteria, much larger than the bacterial volume of colloids, rust, county floating matter, sediment, macromolecules and other organic matter was intertwined, thus achieving the purification process of tap water.

采用PAN合金超滤膜丝，每米长的超滤膜丝壁上有80亿个0.01微米的微孔其孔径只有水分子，水中的有益矿物质和微量元素可以通过，而最小细菌的体积都在0.02微米以上，因为细菌，比细菌体积大得多的胶体，铁锈，县浮物，泥沙，大分子有机物等被截留下来，从而实现了自来水的净化过程。

## Our Products

### 本公司产品



- Replaceable cartridge
- 3 - 5 years or so for a change
- Good machine with a good core
- 可更换滤芯
- 3-5年左右换一次
- 好机用好芯



8 billion 0.01  
micron micropores  
80亿0.01微米的微孔



alloy ultrafiltration  
membrane wire.  
合金超滤膜线。



## Intelligent lock water ring design

### 智能锁水环设计



To prevent leakage, simple structure, easy installation, easy for the core, from the details reflect the quality.

防止漏水，结构简单，安装方便，  
换芯便捷，从细节体现品质。

VS



8 screws around the fixed, disassembly the same, Easy to leak.

8个螺丝环绕固定，拆装不变，  
易漏水。

## 304 stainless steel body, creating good quality product

Filter shell made of food grade safety stainless steel, anti-corrosion, no oxidation, no formaldehyde, very peace of mind.

### 304 不锈钢之身， 造就优良品质

滤壳采用食品接触不锈钢打造，抗腐蚀，不氧化，无甲醛，很安心。





# Product Specification

## 产品规格

### Model: New-IW 1.0 Series

Usage/适用于:	Suitable to install below kitchen sink Space saving. 适合安装在厨房洗手槽下方, 节省空间。
Dimension/直径:	114.3x 200mm ( 4.5" x 20 Inches )
Connector/连接器:	3/4Inches or 1/2 Inches
Flow Rate/流量:	1000 Liter P/Hour



### Model: IW 2.0 Series

Usage/适用于:	Suitable to install on landed house or condominium 适合安装在房屋或公寓
Dimension/直径:	114.3x 762mm ( 4.5" x 30 Inches )
Connector/连接器:	3/4Inches or 1/2 Inches
Flow Rate/流量:	2000 Liter P/Hour



### Model: New-IW 3.0 Series

Dimension/直径:	114.3x 914.4mm ( 4.5" x 36 Inches )
Connector/连接器:	3/4Inches or 1/2 Inches
Flow Rate/流量:	2500 Liter P/Hour



# Itsaso Water UF Filter Backwash Manual

## Itsaso Water UF过滤器反洗手册

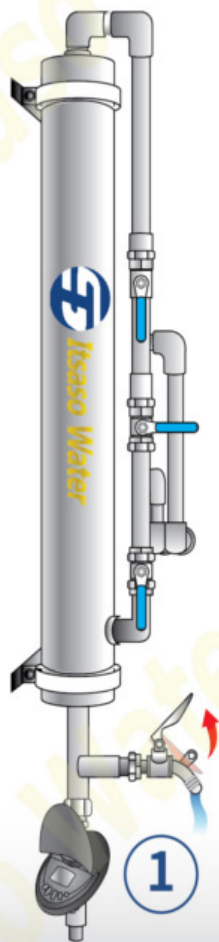

### Forward Flushing 正向冲洗

Advisable to be done at least once a week  
建议每周至少做一次

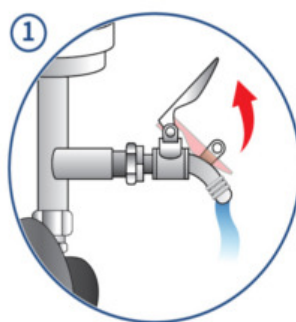

Pull up the water tap to let  
the sewage flow out  
打开水龙头让污水流出

### Back Wash 反向清洗

Advisable to be done at least twice a month  
建议每月至少做两次

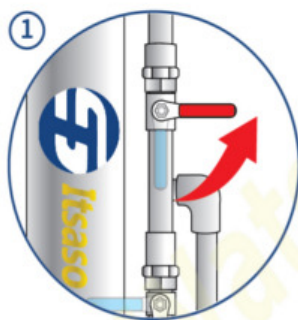

Wrap the wrench up  
把扳手往上掰

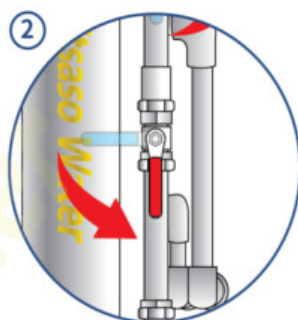

Wrap the wrench down  
把扳手往下掰

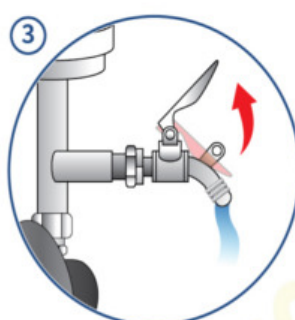

Pull up the water tap to let  
the sewage flow out  
打开水龙头让污水流出

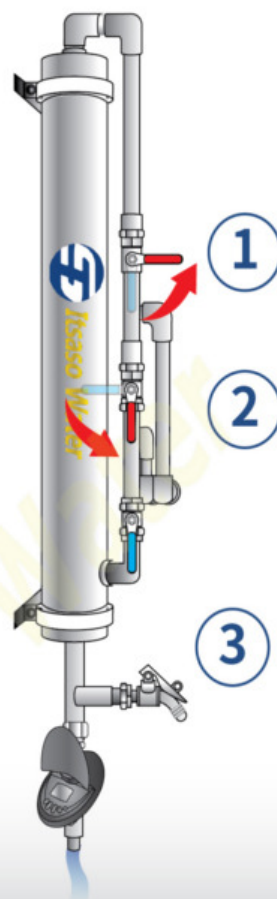

# Itsaso Water UF Filter Backwash Manual

## Itsaso Water UF过滤器反洗手册

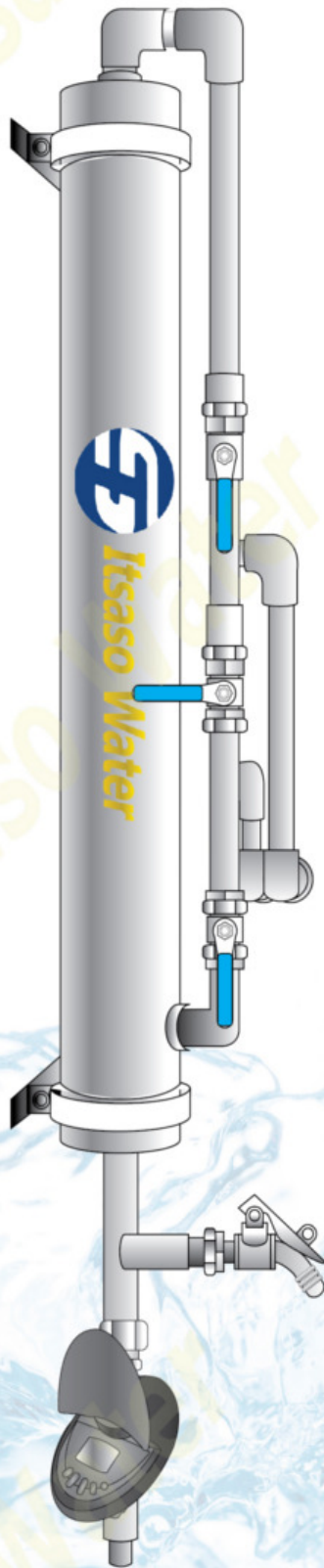

### Normal Filtration 正常过滤

To ensure the service life,  
please carry out two cleaning steps

欲保证使用寿命，  
须进行一下两项清洗步骤



# Auto Flush Timer Controller

## 自动冲洗定时器控制器



The auto flush timer controller is a state of the art automatic irrigation controller designed for residential use. Ideal for rooftop gardens, flower planters, raised beds, or to run an entire irrigation system. The easy to use six button programming system enables you to set each day individually or program the week as a whole. Save water, time and money with this invaluable garden accessory.

自动冲洗定时器控制器是一种用于住宅用途的最先进的自动灌溉控制器。理想的屋顶花园，花盆或运行整个涉水系统。易于使用的六按钮编程系统使您可以单独设置每一天或整个星期的程序。节省用水，时间和金钱与这个无价的涉水配件。

## Product Features

### 产品特点



Easy to use — no plumbing required!  
易于使用 - 不需要另加管道



Female in and male out  
hose connections  
公和母管道连接



Watering duration from 1 minute to  
12 hours (up to 4 starts per day)  
运行持续时间为1分钟至12小时  
(每天最多4次)



Functioning pressure: 15-145 PSI  
功能压力: 15-145 PSI



Ideal for all watering applications  
适用于所有涉水应用



Operated by one 9V battery  
(not included)  
由一个9V电池操作(不包括在机体内)